

\$219,000 - 8517 Springdale Ridge Drive, Austin

MLS® #6724956

\$219,000

0 Bedroom, 0.00 Bathroom,
Land on 1 Acres

Belvedere Ph Vii-B, Austin, TX

Stunning 1.2 acre lot in the coveted gated community of Belvedere. This beautiful acre offers a building site with panoramic Hill Country views. Build the home of your dreams with no attached builder in the award-winning Lake Travis School District. Amenity center offers kitchen, covered outdoor BBQ & living area, lazy river pool, private fishing ponds, trails, children's play area and sports court. Enjoy the finest of Hill Country luxury living in this private neighborhood! Restrictions: Yes

Essential Information

MLS® #	6724956
Price	\$219,000
Bathrooms	0.00
Acres	1.26
Type	Land
Sub-Type	Unimproved Land
Status	Active Under Contract

Community Information

Address	8517 Springdale Ridge Drive
Area	LS
Subdivision	Belvedere Ph Vii-B
City	Austin
County	Travis
State	TX
Zip Code	78738

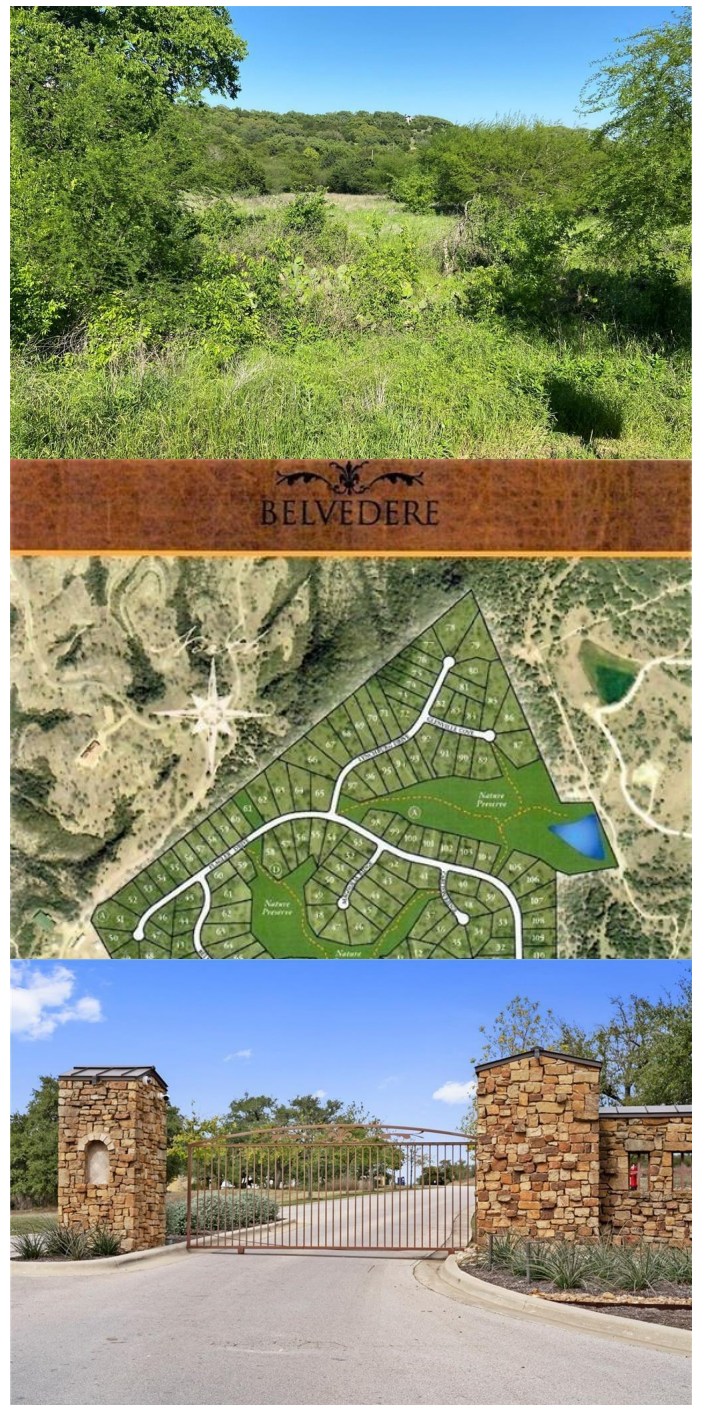

Amenities

Utilities	Electricity Available, Phone Available, See Remarks, Underground Utilities
Features	Common Grounds/Area, Community Mailbox, Gated, Playground, Pool, Trails/Paths
Parking	None
View	Hills, Panoramic
Waterfront	None

Interior

Heating	None
---------	------

Exterior

Lot Description	Backs to Greenbelt/Park, Interior Lot, See Remarks, Trees Medium Size, Trees Small Size
-----------------	---

School Information

District	Lake Travis ISD
Elementary	Bee Cave
Middle	Bee Cave Middle School
High	Lake Travis

Additional Information

Date Listed	April 14th, 2020
Days on Market	160
Zoning	Zoned

Property Listed by: Compass RE Texas, LLC
The information being provided is for consumers' personal, non-commercial use and may not be used for any purpose other than to identify prospective properties consumers may be interested in purchasing. Based on information from the Austin Board of REALTORS® (alternatively, from ACTRIS) from October 29th, 2020 at 11:48pm CDT. Neither the Board nor ACTRIS guarantees or is in any way responsible for its accuracy. The Austin Board of REALTORS®, ACTRIS and their affiliates provide the MLS and all content therein "AS IS" and without any warranty, express or implied. Data maintained by the Board or ACTRIS may not reflect all real estate activity in the market. All information provided is deemed reliable but is not guaranteed and should be independently verified.